



# SunLink RMS Wire Management

The SunLink RMS integrated wire management solution will help you achieve new levels of installation efficiency. Customers who have used our wire management report saving an average of 40% in on-roof time compared with other wire management strategies.

## Seamless Integration

The SunLink RMS wire management solution fits seamlessly with existing SunLink RMS hardware. This integrated approach enhances performance, durability, installation efficiency and aesthetics.

## 40% Faster

Installing the SunLink RMS wire management solution requires no on-roof fabrication. Components simply snap in place. Whether north-south or east-west, assembly requires only one tool and three components per run. Splices, t-joints and cross-joints make any configuration easy. Plus, the solution employs single-point grounding, requiring only one ground lug per continuous, connected tray section.

## Lower Cost + Higher Quality

Our solution is a fraction of the cost of zip ties, conduit and other wire management tools. When you buy the SunLink RMS wire management solution, you get a product manufactured with premium quality corrosion-resistant aluminum without a premium price tag.

## Superior Wire Protection

The SunLink RMS wire management solution eliminates dangerous wire clutter on the roof — guarding against accidents, shorts and wire damage. Both the wire management system hardware and the wires and cables it protects will maintain day-one quality for the entire lifespan of your solar array.

## Wire Management Fast Facts

- Saves time and money compared with zip ties and traditional installation methodologies.
- Designed from the start as a companion to the SunLink RMS for maximum efficiency, simplicity and cost savings.
- Dramatic on-roof labor reductions achieved through snap-in-place installation.
- Top quality materials and engineering ensure safety and durability for the lifetime of the solar array.
- Superior aesthetics that building owners appreciate.
- Requires fewer current de-rating factors than wires in conduit.



## Sunlink. Install Confidence.

SunLink Corporation provides scalable solar module mounting systems and integrated balance of system solutions that reduce total installed costs and improve design flexibility. Leading integrators and installers have chosen SunLink's commercial rooftop and ground-mounted systems on more than 200 MW of projects at 1000+ sites across North America. SunLink's experienced engineering team provides comprehensive customer service for each installation. Our fully customizable racking systems support modules from nearly every manufacturer.

### TRAY COMPONENTS



Wire Tray

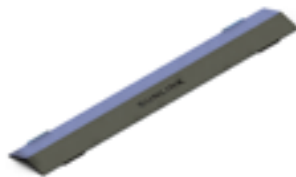

Tray Cover



Long Link Bracket



Hinge

### CLIP COMPONENTS



S Clip



Spar Clip



Long Link Clip

### TECHNICAL SPECIFICATIONS

**When installed as a metallic wireway the following specifications are applicable:**

Size of Conductors	8 GA or smaller
Maximum # of Conductors	Up to 50. See NFPA70 : NEC Article 376.21
Cross-Sectional Area of Wire Tray	4 in <sup>2</sup>
Ampacity Adjustment Factor Calculations	Per NEC 376.22 (B), adjustment factors in 310.15(B)(2) shall be applied only where the number of current carrying conductors exceeds 30. When calculating adjustment factors per NEC 310.15(B)(2)(c) note the Wire Tray is typically 1-3 in. off the surface of the roof.
Compliant with Specifications	<ul style="list-style-type: none"> <li>• NFPA70 : NEC Article 376.21</li> <li>• UL ZOYX</li> </ul>

Can also be used as a ventilated cable tray compliant with NFPA70 : NEC Article 392.

## SunLink® Corporation

San Rafael, CA  
 (t) 415.925.9650  
 (f) 415.925.9636  
 (e) info@sunlink.com

